

SMA Plug (male) Connector 4 Straight Field Replaceable  
6.35mm (.250 inch) Hole Spacing DC-18GHz VSWR1.25

**SMA1BF50-0012B / 9XX**

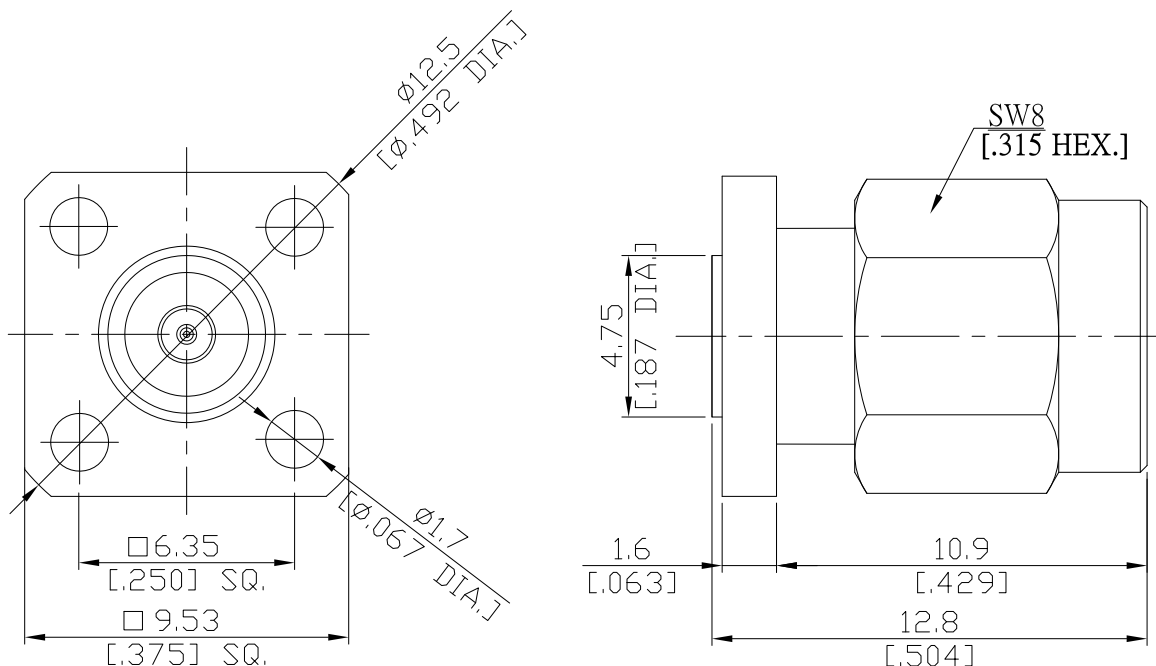

All dimensions are in mm [inch]

Tolerances according to DIN ISO 2768-mH

**Interface**

According to

IEC 60169-15; MIL-STD-348B/310

**Electrical Data**

Impedance	50 $\Omega$
Frequency	DC to 18 GHz
VSWR (Return Loss)	$\leq 1.25$ ( $\geq 19.1$ dB)
Insertion Loss	$\leq 0.04 \times \sqrt{F}$ (GHz) dB
Insulation Resistance	$\geq 5$ G $\Omega$
Center Contact Resistance	$\leq 3.0$ m $\Omega$
Outer Contact Resistance	$\leq 2.0$ m $\Omega$
Test Voltage	1000 V rms
Working voltage	480 V rms
Power handling	$\leq 200$ W @ 2 GHz
RF-leakage	$\geq 100$ dB up to 1 GHz

**Material And Plating**

Piece Parts	Material	Plating
Centre contact	Beryllium Copper	Gold plating, 3 pinch (Non-magnetic nickel-phosphorus underplating, 80 pinch)
Body	Stainless Steel	Passivated
Insulator	PTFE	
Gasket	Silicone Rubber	
Coupling nut	Stainless Steel	Passivated

SMA Plug (male) Connector 4 Straight Field Replaceable  
6.35mm (.250 inch) Hole Spacing DC-18GHz VSWR1.25

## SMA1BF50-0012B / 9XX

### Mechanical Data

Coupling mechanisms	Screw-lock
Mating Cycles	≥ 500
Captivated Type	Mechanical
Center Contact Captivation: axial	≥ 27 N
Coupling Test Torque	1.70 Nm
Recommended Torque	0.80 Nm to 1.1 Nm

### Environmental Data

Temperature Range	-65°C to +165°C
Thermal shock	MIL-STD-202, Meth. 107, Cond. B
Corrosion	MIL-STD-202, Meth. 101, Cond. B
Vibration	MIL-STD-202, Meth. 204, Cond. D
Shock	MIL-STD-202, Meth. 213, Cond. I
Moisture Resistance	MIL-STD-202, Meth. 106
RoHS	compliant

### Packing

Single or 100